

# 4250 WHITE PLAINS ROAD

BRONX, NY

EXCLUSIVE LISTING

## ONE SPACE LEFT!

BLOCK 4999 | LOT 49

## RETAIL/OFFICE BUILDING

FOR  
LEASE | EXCLUSIVE



### BUILDING FEATURES

- Stand-alone Retail Building
- Block 4999; Lot 49
- ONLY 1 Space Available
  - 552 SF
  - 1,286 SF
  - 1,680 SF
- Total Floor Area is 11,000 SF, Lot is 11,450 SF
- Approximately 20 FT of Frontage
- Busy area, great foot traffic
- Neighboring tenants include: Burger King, Met Foods and Capital One Bank
- Single-story building
- Call for Pricing and additional information

### ACCESS

- Right off 233<sup>rd</sup> Street highway exit
- Subway at White Plains Road and 233<sup>rd</sup> Street at corner

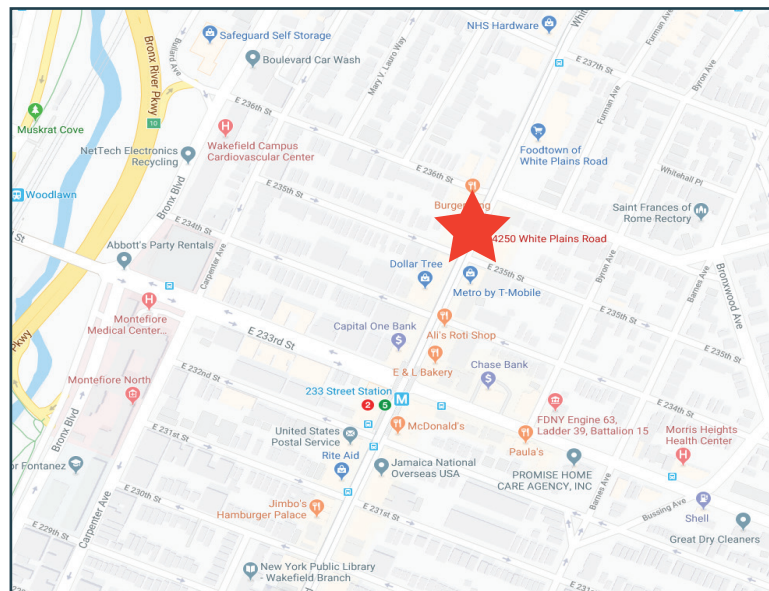

**CONTACT** AYALL SCHANZER | 914.708.3041  
aschanzer@greiner-maltz.com

ATANU BHATTACHARJEE | 914.708.3038  
atanu@greiner-maltz.com

**GREINER-MALTZ**

REAL ESTATE  
Creating Opportunities Together

# 4250

# WHITE PLAINS ROAD

BRONX, NY

EXCLUSIVE LISTING

## ONE SPACE LEFT!

BLOCK 4999 | LOT 49

## RETAIL/OFFICE BUILDING

FOR  
LEASE | EXCLUSIVE

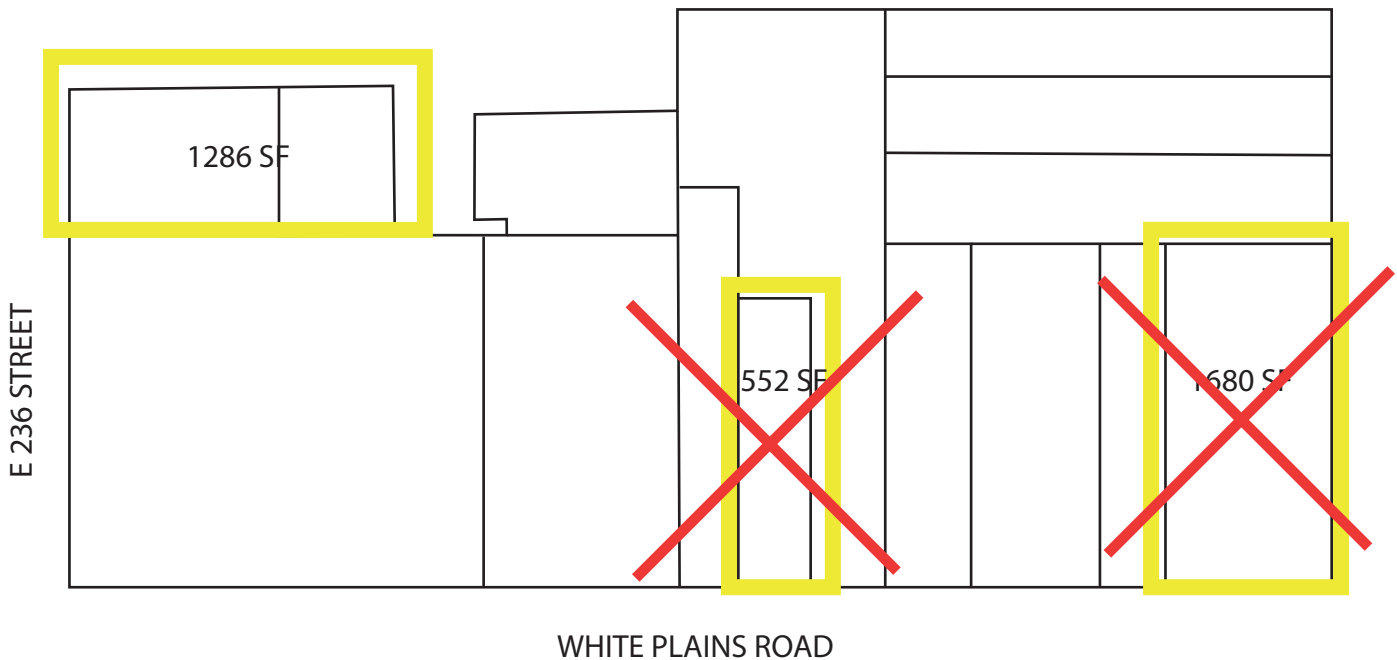

**CONTACT** **AYALL SCHANZER** | 914.708.3041  
aschanzer@greiner-maltz.com  
**ATANU BHATTACHARJEE** | 914.708.3038  
atanu@greiner-maltz.com

**GREINER-MALTZ**  
REAL ESTATE  
Creating Opportunities Together